

SD600DP PRIMARY SHAKER

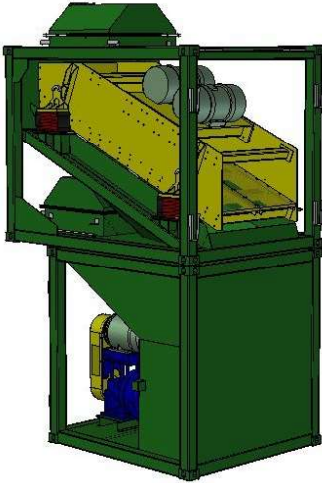

The SD600DP Primary Shaker is a high capacity, declined, single deck shaker with 2 No. discharge pumps, used for the separation of coarse particles or clay balls. The SD600DP consists of a shaker module, which mounts on top of a pump tank module. These two units wedge together to form an ISO Type 1CC 20 foot ISO container sized unit for transport. The machine also includes a free-standing Metso pump which is transported separately.

The shaker is mounted within a heavy duty hollow section steel frame which also houses a rubber lined mud feed header box and trough for collection of the shaker underflow. The shaker has a screening area of 3600x1400mm and is normally fitted with heavy duty stainless steel wedge wire screens with 8x40mm long slotted apertures with the slots parallel to the direction of flow. Separated solids are discharged off the front of the shaker, outside the end face of the pump tank. Screened mud exits the bottom of the shaker unit and discharges, by gravity, into the pump tank. The shaker

is powered by 2 No. 6.2kW motors fitted with eccentric weights and with Direct-On-Line starting.

The pump tank module consists of a heavy duty hollow section steel frame which houses a tank into which the shaker underflow falls and 1 No. Metso MM200 centrifugal pump with overhead mounted 45kW electric motor. An additional free-standing MM200 pump with 45kW motor and the integral pump are used to discharge the screened fluid from the SD600DP to downstream equipment, such as an SM450PSDP or two SM300PSDP units for finer cleaning. The pump tank is also fitted with a 20" diameter mud level balancing pipe which connects the SD600DP to adjacent units.

TECHNICAL DATA

Transport:	Transport weight: 14 tonnes. Transport size: 6058x2438x2591mm high, with ISO corner castings, plus the free-standing pump. The machine can be transported one standard type 1CC 20' container plus the free-standing pump.
Shaker module:	Shaker: Single-deck shaker declined with 2 No. 6.2kW motors with DOL starting. Screens: Normally heavy duty wedge wire with 8x40mm slotted apertures.
Pump tank module:	Discharge pump: 1 No. Metso MM200 centrifugal pump with 45kW motor plus 1 No. free-standing MM200 pump with 45kW motor.
Operating size:	4000x2500x5900mm high.
Operating weight:	20 tonnes.
Power:	380-415V, 50Hz, 3-phase & earth no neutral. Total power requirement is 103kW.
Running current:	approx 145A per phase.
Starting current:	approx 290A per phase.
Fluid throughput:	Flowrates of up to 600m ³ /hr with low viscosity muds.

Specification subject to change without notice.

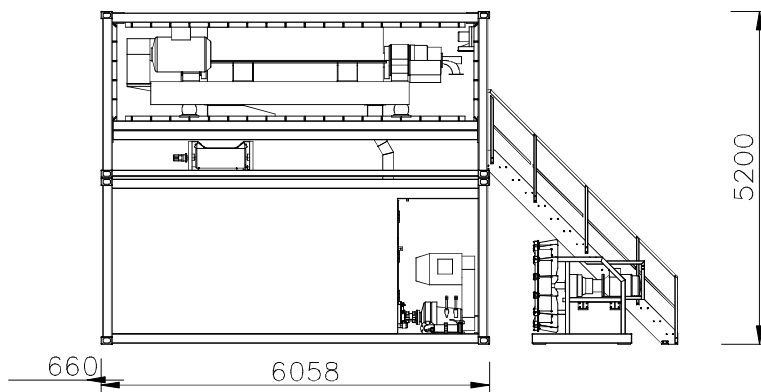
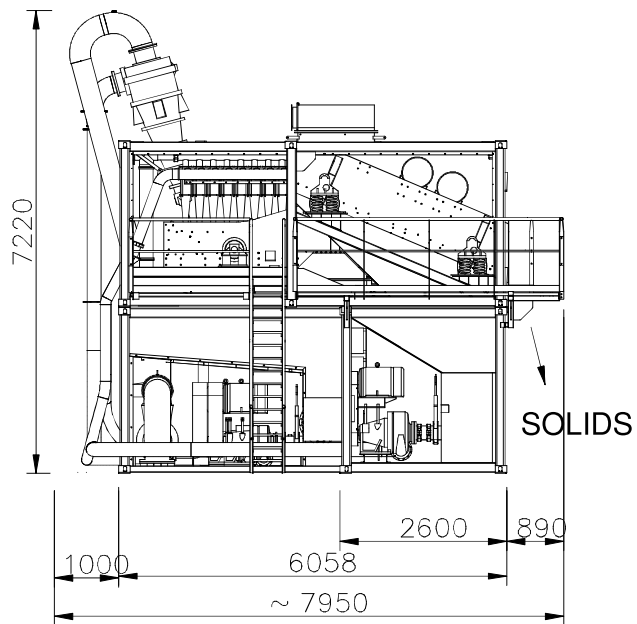
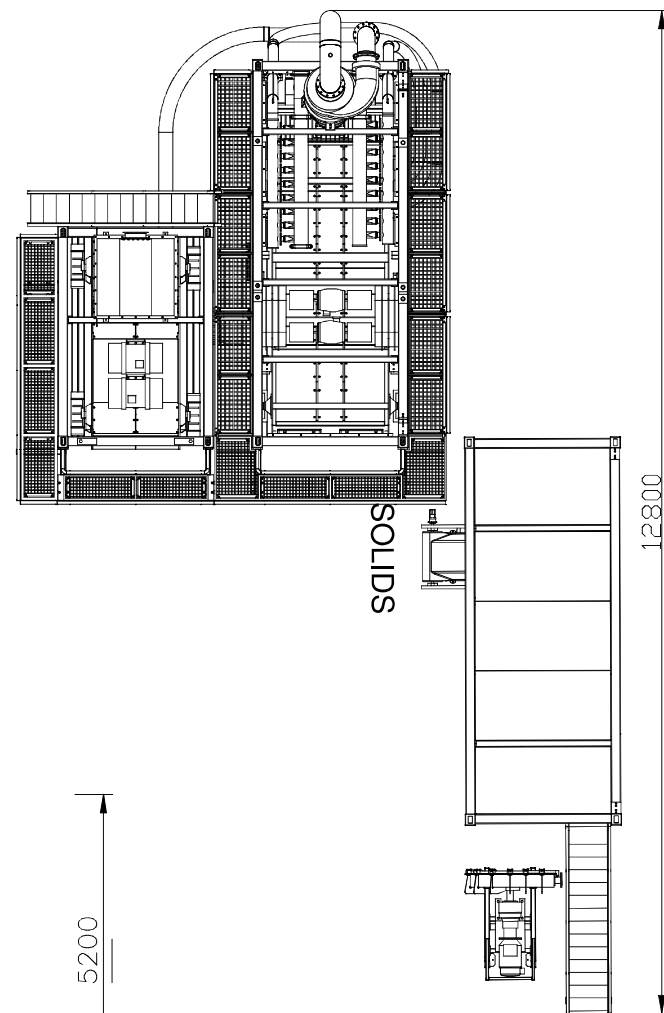
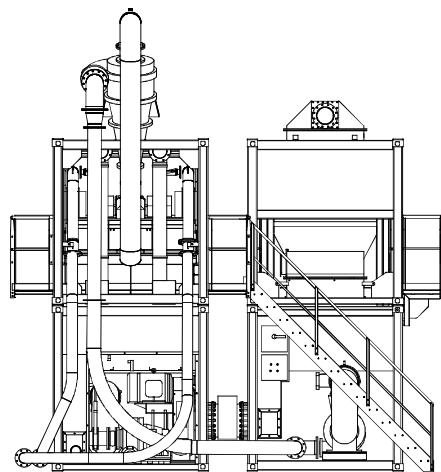
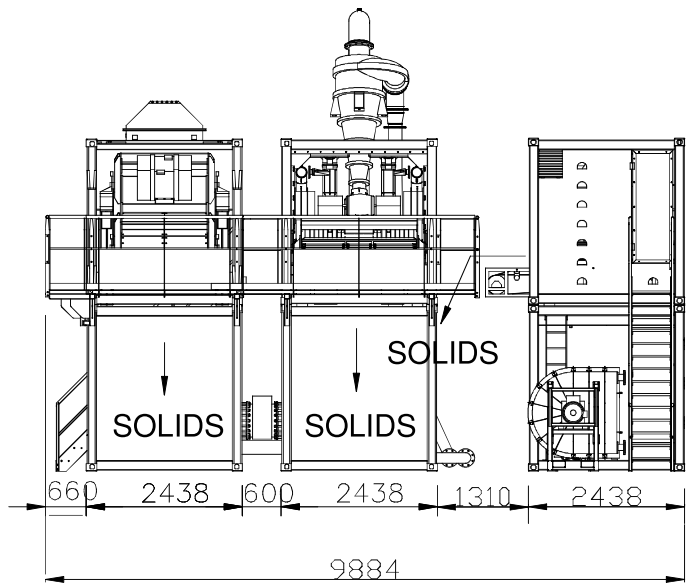

Drawn by:

GBS

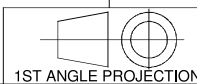

Name: SD600DP & SM500PSDP
S4 LAYOUT -INTEGRA

ACP_006

Date: 09/11/12

Rev B